

4CRDI LED

4" Compact Direct/Indirect Cylinder – Round

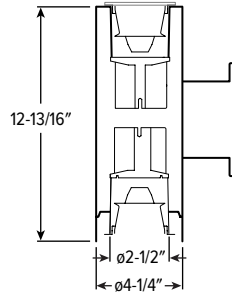

CATALOG #: _____

TYPE: _____

PROJECT: _____



ORDERING EXAMPLE: 4CRDI - 13 - L12/835U/L12/835D - RDB - OPTIONS - WHT - CONTROL/DIM - UNV - OW/LM - CS - TRIM OPTIONS - WM
 HOUSING TRIM MOUNT

HOUSING

SERIES	HEIGHT	LUMEN PACKAGE (Example: L12/835U/L9/835D)	REMOTE	OPTIONS	HOUSING FINISH ^[1]
4CRDI	13 13"	Specify lumen packages: U for Up and D for Down LUMENS ^[3] CRI CCT U OR D L9 900lm 8 80 27 2700K U Uplight L12 1,200lm 9 90 30 3000K D Downlight L15 1,500lm 35 3500K 40 4000K 50 5000K	RDB Remote mount control/driver box, galvanized steel ^[2]	See page 3 for EMERGENCY BATTERY OPTIONS .	ALUM Silver sparkle aluminum BLK Textured black BRZ Textured bronze NKL Textured nickel SLV Textured silver WHT Textured white

CONTROL

See page 3 for **ADDITIONAL CONTROL/ DRIVER OPTIONS**.

- None
- AVI-LVFA** Avi-on wireless fixture control ^[4]
- AWNDR** Lutron Athena wireless node fixture control, RF only ^[5]

DRIVER

See page 3 for **ADDITIONAL CONTROL/ DRIVER OPTIONS**.

- DIM** Entire fixture switches and dims together
- DIM1** 1% Dimming driver, 0-10V
- DA** Driver with 12V auxiliary power, without external dimming wires ^[6]

VOLTAGE

- UNV** 120-277V
- 347** 347V ^[7]

TRIM

TRIM TYPE AND DISTRIBUTION ^[8]

(Example Uplight/Downlight: **OW/LM**)

TRIM TYPE

- Uplight**
 - O Open reflector with clear glass shield ^[13]
- Downlight**
 - O Open reflector
 - L Flush lens
 - R Regressed lens

DISTRIBUTION

- Uplight**
 - W 70° Wide
 - M 40° Medium
 - N 15° Narrow ^[14]
 - S 8° Narrow spot ^[15]
- Downlight**
 - W 70° Wide
 - M 40° Medium
 - N 15° Narrow
 - S 8° Narrow spot ^[16]

REFLECTOR FINISH ^[9]

Downlight Open Trim Types

- CS** Clear semi-specular anodize
- SG** Satin-glow anodize
- GD** Gold anodize
- CG** Champagne gold anodize
- PW** Pewter anodize
- SPC** Clear specular anodize
- RG** Rose gold anodize
- WH** White texture powder coat
- BL** Black texture powder coat

Downlight Lens Trim Types

- CS** Clear semi-specular powder coat
- WH** White texture powder coat
- BL** Black texture powder coat
- BZ** Bronze texture powder coat
- NK** Nickel texture powder coat
- SV** Silver texture powder coat
- AL** Silver sparkle aluminum

TRIM OPTIONS

- AD** Diffuse acrylic lens ^[10]
- PD** Diffuse 1/8" polycarbonate lens ^[11]
- TD** Diffuse polycarbonate lens media at top of open reflector ^[12]

MOUNTING

MOUNTING TYPE ^[17]

- WM** Wall mount

NOTES

- ¹ See page 4 for HOUSING FINISH DETAILS.
- ² Painted driver box available, specify RDB/BLK or RDB/WHT.
- ³ Lumen output based on O Trim Type, W Distribution and CS Reflector Finish, 80 CRI/3500K CCT. Actual performance may vary +/-5%. See page 2 for FIXTURE PERFORMANCE DATA.
- ⁴ DA Driver only. See page 5 for AVI-ON BLUETOOTH WIRELESS CONTROL DETAILS.
- ⁵ DA Driver only.
- ⁶ Avi-on and Lutron Athena Controls only.
- ⁷ Not available with EM batteries or DA drivers.
- ⁸ Beam angle based on O Trim Type and CS Reflector Finish. Trim Type affects beam angle. See page 2 for FIXTURE PERFORMANCE DATA.

- ⁹ Specified for Downlight Trim Type only. See page 4 for REFLECTOR FINISH DETAILS.
- ¹⁰ Not available with O Trim Type. Downlight only. W Distribution only.
- ¹¹ Not available with O Trim Type. Downlight only. W Distribution only.
- ¹² O Trim Type only. Downlight only.
- ¹³ CS Reflector Finish standard. Other colors available, consult factory.
- ¹⁴ O Trim Type only.
- ¹⁵ Not available with L Trim Type or 950 CRI/CCT.
- ¹⁶ Not available with 950 CRI/CCT.
- ¹⁷ See page 4 for FIXTURE DETAILS.



4CRDI^{LED} 4" Compact Direct/Indirect Cylinder – Round

FEATURES

- Engineered to deliver great performance in a sleek, space-saving design
- Smoothly accent walls and eliminate dark ceilings with direct and indirect lighting
- Parallel the performance and style of the Williams downlight collection
- Superior optical control with beams as narrow as 8° and field changeable optics as wide as 70°
- Complement the architectural elements of any space with a multitude of housing and trim finishes
- Precision-engineered extruded aluminum housing and die-cast aluminum trim face for clean aesthetic
- Low UGR meets LEED and WELL requirements
- Wireless in-fixture control solutions available

SPECIFICATIONS

- HOUSING** – Extruded aluminum with die-cast aluminum accent ring.
- FINISH** – Polyester powder coat bonded to phosphate-free, multi-stage pretreated metal. All parts painted after fabrication to facilitate installation, increase efficiency, and inhibit corrosion.
- OPEN REFLECTOR** – Low-iridescent anodized aluminum. Clear semi-specular finish standard.
- LENSED TRIM** – Die-cast aluminum frame with micro-prismatic, acrylic lens.
- ELECTRICAL** – High-performance Class 2 C.O.B. LED array. Modular quick-connect plug for easy field-connection of LED light assembly to driver. Reported L70>55,000 hours. Reported L90 = 49,000 hours. Estimated L70 = 179,000 hours.
- MOUNTING** – Wall mount. Indoor applications only. Control, driver, and EM battery installed in remote mount box.
- LISTINGS** –
 - cCSAus conforms to UL STD 1598 and UL STD 8750. Certified to CAN/CSA STD C22.2 No. 250.0. Suitable for dry and damp locations.
 - Complies with the Buy American Act and other federal regulations. Request certification at hew.com/baa.
- WARRANTY** – 5-year limited warranty, see hew.com/warranty.

FIXTURE PERFORMANCE DATA

DIST.	WATTAGE	DOWNLIGHT						UPLIGHT			
		OPEN REFLECTOR		FLUSH LENS		REGRESSED LENS		WATTAGE	OPEN REFLECTOR		
		DELIVERED LUMENS	EFFICACY (lm/W)	DELIVERED LUMENS	EFFICACY (lm/W)	DELIVERED LUMENS	EFFICACY (lm/W)		DELIVERED LUMENS	EFFICACY (lm/W)	
L9	W	10.7	929	87	973	91	963	90	10.6	760	72
	M	10.7	898	84	958	90	917	86	10.6	734	69
	N	10.7	799	75	950	89	927	87	10.6	653	62
	S	14.1	807	57	1115	79	1075	76	14.0	660	47
L12	W	14.3	1267	89	1327	93	1313	92	14.2	1036	73
	M	14.3	1224	86	1307	91	1250	87	14.2	1001	70
	N	14.3	1000	70	1296	91	1264	88	14.2	818	58
	S	20.4	1071	53	1480	73	1427	70	20.2	876	43
L15	W	17.7	1571	89	1645	93	1628	92	17.5	1285	73
	M	17.7	1518	86	1620	92	1550	88	17.5	1241	71
	N	17.7	1240	70	1607	91	1567	89	17.5	1014	58
	S	26.7	1326	50	1832	69	1767	66	26.5	1084	41

- Photometrics tested in accordance with IESNA LM-79. Results based on CS (O Trim Type) or WH (L and R Trim Types) Reflector Finish, W Distribution, 80 CRI/3500K CCT, average wattage for 120V input, and 25°C ambient temperature. Actual performance may vary +/-5%.
- Wattage is for downlight or uplight components. Add wattages together for selected lumen packages to find total fixture wattage.
- To calculate lumen output in emergency mode, multiply the battery wattage by the efficacy.
- Use multiplier tables to calculate additional options.

MULTIPLIER TABLES

	COLOR TEMPERATURE	
	CCT	CONVERSION FACTOR
	80 CRI	2700K
	3000K	0.98
	3500K	1.00
	4000K	1.01
	5000K	1.02
90 CRI	2700K	0.76
	3000K	0.79
	3500K	0.82
	4000K	0.84
	5000K	0.88

	REFLECTOR FINISH	
	CATALOG NUMBER	CONVERSION FACTOR
	O TRIM	CS
	SG ⁽¹⁾	0.92
	GD	0.93
	CG	0.96
	PW	0.86
	SPC	1.02
	RG	0.88
	WH ⁽¹⁾	0.89
	BL ⁽¹⁾	0.47

TRIM OPTIONS	
CATALOG NUMBER	CONVERSION FACTOR
AD	0.85
PD	0.85
TD	0.67

	R TRIM		
	CATALOG NUMBER	CONVERSION FACTOR	
		WH	1.00
		CS ⁽¹⁾	0.98
		BL ⁽¹⁾	0.79
		BZ ⁽¹⁾	0.76
	NK ⁽¹⁾	0.81	
	SV ⁽¹⁾	0.81	
	AL ⁽¹⁾	0.86	

BEAM ANGLE

	TRIM TYPE		
	OPEN	FLUSH	REGRESSED
W	70°	50°	55°
M	40°	30°	30°
N	15°	20°	20°
S	8°	14°	14°

¹ Distribution will also be affected, consult factory.

PHOTOMETRY

4CRDI-13-L12/835U/L12/835D-WHT-DIM1-UNV-OW/OW-CS-WM Total Luminaire Output: 2228 lumens; 28.5 Watts | Efficacy: 78 lm/W | 80 CRI; 3500K CCT

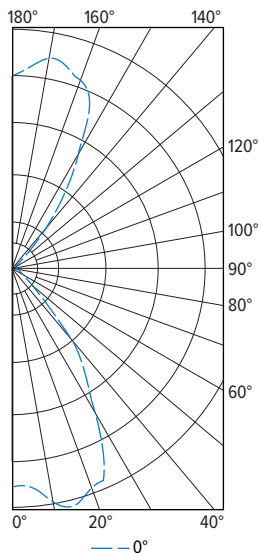

VERTICAL ANGLE	HORIZONTAL ANGLE		ZONAL LUMENS
	0°		
0	948		
5	959		95
15	1059		295
25	917		406
35	514		306
45	72		77
55	19		18
65	6		7
75	3		3
85	2		2
90	2		
95	3		3
105	6		6
115	13		13
125	30		28
135	77		70
145	370		227
155	773		339
165	883		249
175	867		84
180	826		

LUMEN SUMMARY	ZONE	LUMENS	% FIXTURE
	0 - 30	796	36
0 - 40	1102	49	
0 - 60	1196	54	
0 - 90	1208	54	
90 - 120	23	1	
90 - 150	347	16	
90 - 180	1020	46	
0 - 180	2228	100	



4CRDI LED

4" Compact Direct/Indirect Cylinder – Round

OPEN

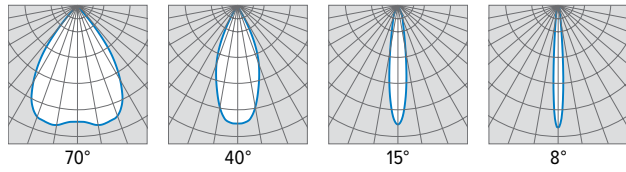

FLUSH

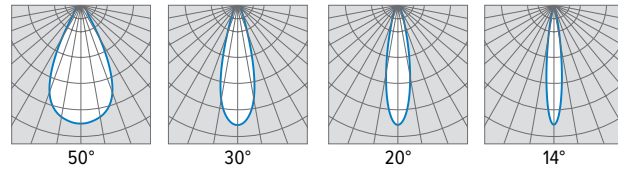

REGRESSED

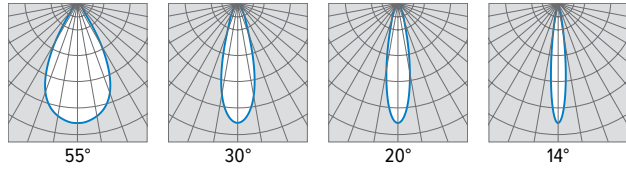

ADDITIONAL CONTROL/DRIVER OPTIONS

DRIVER/CONTROL	DESCRIPTION	RDB DETAILS BY LUMEN STOP ^[1]			
		L9	L12	L15	w/EM
DIM	Dimming driver prewired for 0-10V low voltage applications; entire fixture switches and dims together	RIS	RIS	RIS	RIL
DIMU/DIMD	Dimming driver prewired for 0-10V low voltage applications; up and down portions switch and dim separately	RIS	RIS	RIS	RIL
DIM1	1% dimming driver prewired for 0-10V low voltage applications	RIS	RIS	RIS	RIL
DIM1U/DIM1D	1% dimming driver prewired for 0-10V low voltage applications; up and down portions switch separately	RIS	RIS	RIS	RIL
DIM LINE	Line voltage dimming driver (TRIAC and ELV compatible, 120V only)	RIS	RIS	RIS	RIL
DIM LINEU/DIM LINED	Line voltage switching and line voltage dimming; up and down portions switch separately	RIS	RIS	RIS	RIL
DMX	0.1% dimming driver for DMX controls	RIL	RIL	RIL	RIL
DMX/DMX	0.1% dimming driver for DMX controls; up and down portions switch separately	RIL	RIL	RIL	RIL
DALI	DALI dimming driver	RIL	RIL	RIL	RIL
DALI/DALI	DALI dimming driver; up and down portions switch separately	RIL	RIL	RIL	RIL
LDE1	Lutron Hi-lume 1% EcoSystem dimming LED driver	RIL	RIL	RIL	RIL
LDE1/LDE1	Lutron Hi-lume 1% EcoSystem dimming LED driver; up and down portions switch separately	RIL	RIL	RIL	RIL
AVI-LVFA/DA	Avi-on wireless fixture control for use with driver with 12V auxiliary power. Up and down switch together.	RIL	RIL	RIL	RIL
AVI-LVFA/DA-U/D	Avi-on wireless fixture control for use with driver with 12V auxiliary power. Up and down switch separately.	RIL	RIL	RIL	RIL
AWNDR/DA	Lutron Athena wireless node fixture control, RF only, for use with driver with 12V auxiliary power. Up and down switch together.	RIS	RIS	RIS	RIL
AWNDR/DA-U/D	Lutron Athena wireless node fixture control, RF only, for use with driver with 12V auxiliary power. Up and down switch separately.	RIS	RIS	RIS	RIL

¹ If using two different stops for U/D, see highest lumen stop for RDB.

REMOTE MOUNT DETAILS

Max remote distance is 50' including suspension. Must be room-side accessible for maintenance.

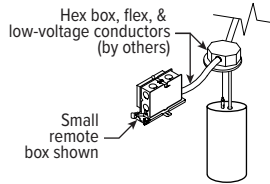

SMALL

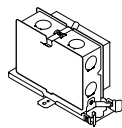

Snap-in Junction Box
6-1/2" x 3" x 4-1/2"

LARGE

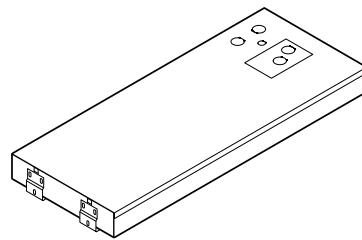

9" x 24" x 2"

REMOTE MOUNT KEY	
RIS	RDB Required, Small Box
RIL	RDB Required, Large box

EMERGENCY BATTERY OPTIONS

Max remote distance 50', including suspension length. Large remote box provided. EM light defaults to downlight output. Specify CEC in option code when California Energy Commission regulations are required.

CATALOG NUMBER	DESCRIPTION
EM/7WRM/RTS	Remote mount 7-watt emergency battery with regressed test switch
EM/10WRM/RTS	Remote mount 10-watt emergency battery with regressed test switch
EM/12WRM/RTS	Remote mount 12-watt emergency battery with regressed test switch ^[1]

¹ Not available when CEC regulations are required.

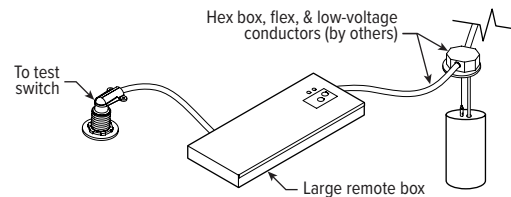

4CRDI^{LED} 4" Compact Direct/Indirect Cylinder – Round

TRIM TYPE DETAILS

DOWNLIGHT

OPEN

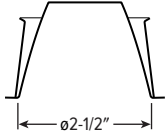

FLUSH

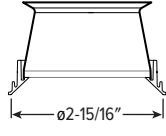

REGRESSED

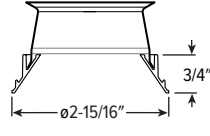

UPLIGHT

OPEN

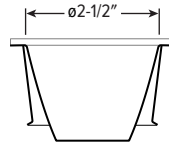

FIXTURE DETAILS

CROSS SECTION

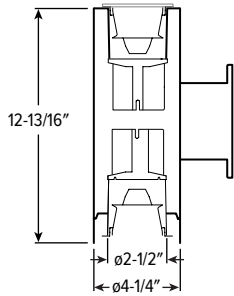

TOP VIEW

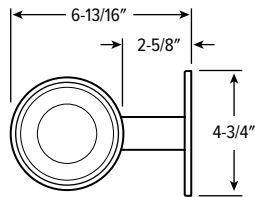

SIDE VIEW

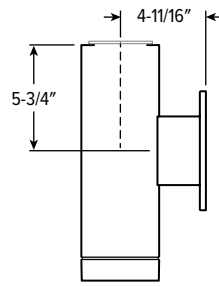

BACK VIEW

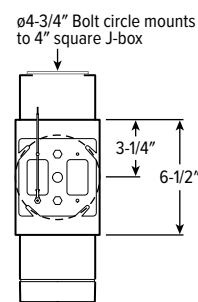

HOUSING FINISH DETAILS

WHITE

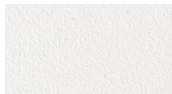

BLACK



BRONZE



NICKEL



SILVER



ALUM



For custom color, please specify RAL code or a manufacturer code with description. All custom colors other than RAL require two sample swatches, minimum 1" square.

REFLECTOR FINISH DETAILS

Smooth Finish SPC

SG



PW



GD



CG



RG



CS



AL



Textured Finish WH

BL

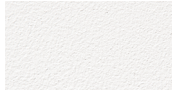

BZ



NK



SV



SEE NEXT PAGE FOR CONTROL DETAILS



4CRDI^{LED} 4" Compact Direct/Indirect Cylinder – Round

AVI-ON BLUETOOTH WIRELESS CONTROL DETAILS

FEATURES

Simple

- Gateway-free distributed control
- Factory pre-commissioning
- Contractor friendly installation
- Occupancy/vacancy/daylight sensing

Scalable

- Virtually unlimited network size
- Spans small offices to large warehouses
- Flexible control strategies

Secure

- Optional cloud connectivity
- UL IoT platinum security rating
- DLC 5.0 compliant

COMMISSIONING & INSTALLATION TOOLS

Avi-on mobile apps provide intuitive, quick installation and commissioning. Pro tools are available to qualified installers. Live commissioning training and on-site or remote support by Avi-on must be ordered separately through Avi-on.



Commissioning Mobile App



Zone Scanner Web App



Commissioning Pro App

SYSTEM COMPONENTS

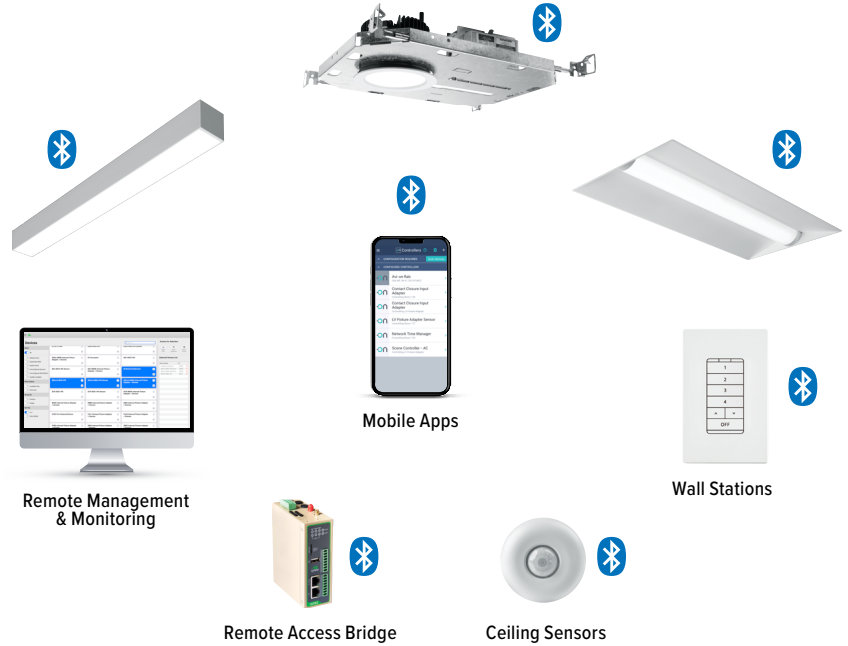

The Bluetooth® word mark and logos are registered trademarks owned by Bluetooth SIG, Inc. and any use of such marks by Avi-on is under license. Other trademarks and trade names are those of their respective owners.

ACCESSORIES

WALL STATIONS

AVI-2401AC	Scene controller - numbered 1-4, 120-277VAC
AVI-2402BAT	Scene controller - numbered 1-4, battery powered
AVI-2401AC-2	Dimmer with presets - percentages, 120-277VAC
AVI-2402BAT-2	Dimmer with presets - percentages, battery powered
AVI-2401AC-3	On/off/dimming, 120-277VAC
AVI-2402BAT-3	On/off/dimming, battery powered

NETWORK

AVI-RAB-LTE	Remote access bridge
AVI-KIT-NTM	Network time manager with battery backup

CEILING MOUNT SENSORS

AVI-KIT-SEN-DUCM	PIR motion and ultrasonic sensor kit
AVI-KIT-SEN-ICM	PIR motion and photocell sensor kit

For load controllers and additional accessory info, see hew.com/avi-on

